



High Pressure, High Performance Vane Pump

35VPF Series – 21 Design

OUT OF PRINT

Service Data

High Pressure, High Performance Vane Pump

35VPF Series – 21 Design

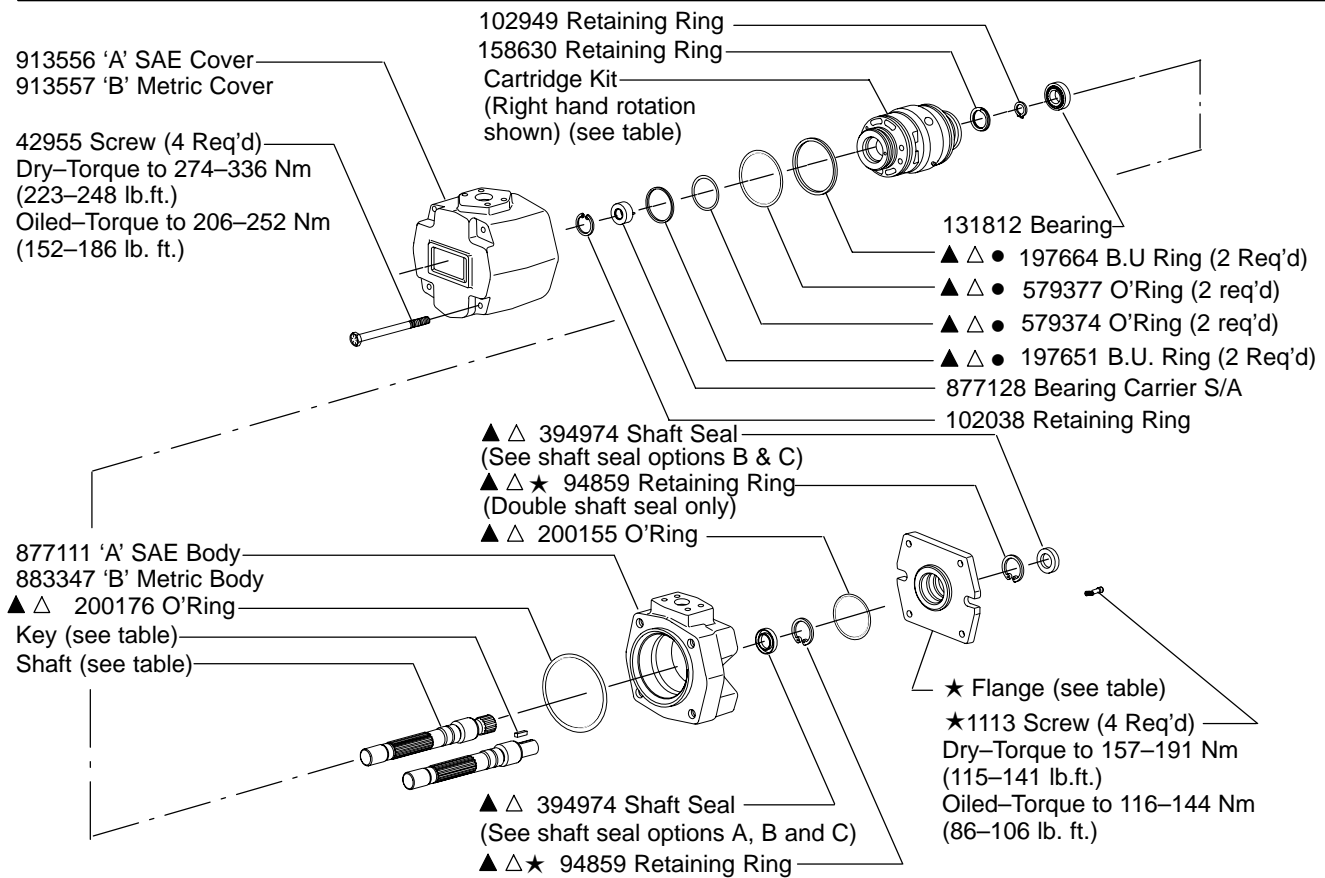

● Included in Cartridge Kit (see table)

★ Included in Flange Kit (see table)

Model Code	Shaft	Key
35VPF-***-***-**-01	883351	928541
35VPF-***-***-**-02	877115	—
35VPF-***-***-**-03	883352	928546
35VPF-***-***-**-05	883353	928542
35VPF-***-***-**-06	883354	—
35VPF-***-***-**-07	883355	928547

NOTE: Lubricate all parts and seals with a thin coat of oil at assembly. Parts prefixed with symbols are available only in kits (see back page).

Flange Type	★ Flange Kit	
	Single Shaft Seal	Double Shaft Seal
SAE J744-127-2 (SAE C)	02-142488	02-142491
ISO 3019/2-125A2HW	02-142489	02-142492
SAE J744 152-2 (SAE D)	02-152287	02-152288
ISO 3019/2-160A2HW	02-142490	02-142493

Model Code	● Cartridge Kit (Standard)	● Cartridge Kit (Viton®)
35VPF-090	02-322011	02-322012
35VPF-100	02-322013	02-322014
35VPF-112	02-322015	02-322016
35VPF-125	02-322017	02-322018
35VPF-135	02-322019	02-322020

Viton® is a registered trademark of E.I. DuPont Co.

Model Code

35VPF - * * * - * - * - * * - * - * - * - 21 - *

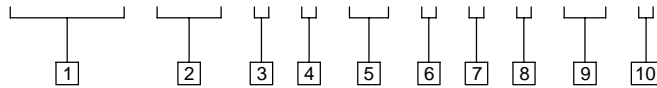

1 Series designation (frame size)

35VPF – 90 to 135 cm³/r
(5.49 to 8.24 in³/r)

2 Displacement

090 – 90 cm³/r (5.49 in³/r)
100 – 100 cm³/r (6.10 in³/r)
112 – 112 cm³/r (6.83 in³/r)
125 – 125 cm³/r (7.625 in³/r)
135 – 135 cm³/r (8.24 in³/r)

3 Port connection

A – SAE 4-bolt flange
B – Metric 4-bolt flange

4 Flange mounting style

A – SAE J744 127–2 (SAE C)
B – ISO 3019/2 125A2HW
C – SAE J744 152–2 (SAE D)
D – ISO 3019/2 160A2HW

- ▲ 02–142423 STD Seal Kit, Single Shaft Seal or 02–142425 Viton® Seal Kit, Single Shaft seal.
- △ 02–142424 STD Seal Kit, Double Shaft Seal or 02–142426 Viton® Seal Kit, Double Shaft Seal.

5 Shaft

01 – SAE J744 32–1
(1.25 in keyed shaft)
02 – SAE J744 32–4
(C splined shaft)
03 – ISO 3019/2 E32N
(32mm keyed shaft)
05 – SAE J744 38–1
(1.50 in keyed shaft)
06 – SAE J744 38–4
(C–C splined shaft)
07 – ISO 3019/2 E40N
(40mm keyed shaft)

6 Shaft seal

A – Single, primary
B – Double, secondary (spring side out)
C – Double, secondary (spring side in)

7 Seal type

N – Standard, Buna N
V – Viton®
W – Buna N with Viton® shaft seal(s)
Viton® is a registered trademark of the E.I. DuPont Co.

8 Outlet port position (viewed from cover end)

A – Opposite inlet port
B – 90° counterclockwise from inlet port
C – Inline with inlet port
D – 90° clockwise from inlet port

9 Design level

10 Rotation (viewed from shaft end)

R – Right hand (clockwise)
L – Left hand (counterclockwise)

To reverse Cartridge rotation remove Retaining Ring and Bearing Carrier S/A. Install Bearing Carrier S/A and Retaining Ring in opposite end of Cartridge and reinstall Cartridge facing in opposite direction. For R.H. rotation the end of the Cartridge with screw heads showing will be installed toward the cover end. For L.H. rotation the end of the Cartridge with screw heads showing will be installed toward the shaft end.

Shaft Seal Option

A – Primary seal only: sealing member facing inward.
B – Primary and secondary seals: primary seal with spring loaded sealing member facing inward and secondary seal with spring loaded sealing member facing outward.
C – Primary and secondary seals: both with spring loaded sealing member facing inward.

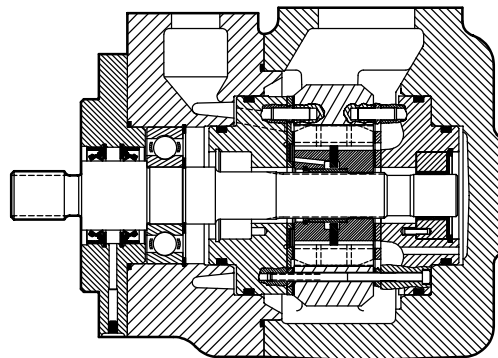

Typical sectional view

Eaton Hydraulics

15151 Highway 5
Eden Prairie, MN 55344
Telephone: 612 937-7254
Fax: 612 937-7130
www.eatonhydraulics.com

46 New Lane, Havant
Hampshire PO9 2NB
England
Telephone: (44) 170-548-6451
Fax: (44) 170-548-7110

