

Service Data

Vickers®

Flow Controls



Single and Dual Feed Control Panels

CPG-06-*A-*-*12

CPG-06-*AA-*-*12

Conversion of a single feed panel to a dual feed panel is accomplished by installing conversion kit 942245. The kit contains the following parts:

Part No.	Name	Qty.
155091	Back-up Ring	1
177537	Spring	1
200978	Spring	1
207638	Plug	1
207772	Shaft	1
207775	Indicator	1
207782	Set Screw	1
224347	Rod	1
224352	Throttle (coarse)	1
262330	"O" Ring	1
349143	Dial S/A	1
349458	Pawl	1
380232	Cover Plate	1

With 207772 Shaft turned in, adjust 207638 Positioning Plug in dial so that "O" on dial lines up with pointer on Cover Plate when Dial is assembled on Shaft. Lock securely with 207782 Set Screw. Insert 207775 Range Indicator so the letter "A" may be seen at range opening in Cover Plate. Repeat procedure for Dual Feed Panel.

*Optional Spacers (Part No. 211026) are available to provide the following maximum flow rates:

No. of Spacers	Approximate maximum controlled flow (cu. in./min.)	
	Fine Feed	Coarse Feed
4	100	400
3	300	800
2	700	1200
1	1100	1400

■ These parts are used only on the Single Feed Panel CPG-06-*A-12. They must be removed if the panel is being converted to dual feed type.

Cover Plate	Model
380234	CPG-06-A-12
380232	CPG-06-AA-12

AX-36212 Screw
(7 req'd)

⊖215588 Roller and 583283 Plunger can be positioned at right angles to the mounting face. Tap out Rollpin, remove Roller and turn Plunger clockwise (CW) 90°. Install Roller and Pin. (See model code.)

●2 required on dual feed panels CPG-06-*AA-12.

▲Included in 919609 Seal Kit

Spool	Rated Flow USgpm	Model
352434	10	CPG-06-10A(A)-12
352435	15	CPG-06-15A(A)-12
352436	20	CPG-06-20A(A)-12
352450	30	CPG-06-30A(A)-12

382302 Retainer

312382 Snap Ring

349457 Cover

188645 Lock

905302 Key
(2 provided)

●349458 Pawl

349459 Wedge

197790 Screw

●177537 Spring

378233 Throttle
(Fine Feed)

●224437 Rod

312382 Snap Ring

390310 Retainer

▲197574 Back-up Ring

▲262336 "O" Ring

348615 Spring

349468 Poppet

349466 Seat

▲262336 "O" Ring

●200978 Spring

●207775 Indicator

315932 Plug

▲263496 "O" Ring

350674 Stop

■ 349476 Plug S/A

■▲155091 Back-up Ring

●▲262330 "O" Ring

●▲155091 Back-up Ring

●207772 Shaft

●207782 Set Screw

*211026 Spacer (See table for optional spacers.)

●207638 Plug

●349143 Dial S/A

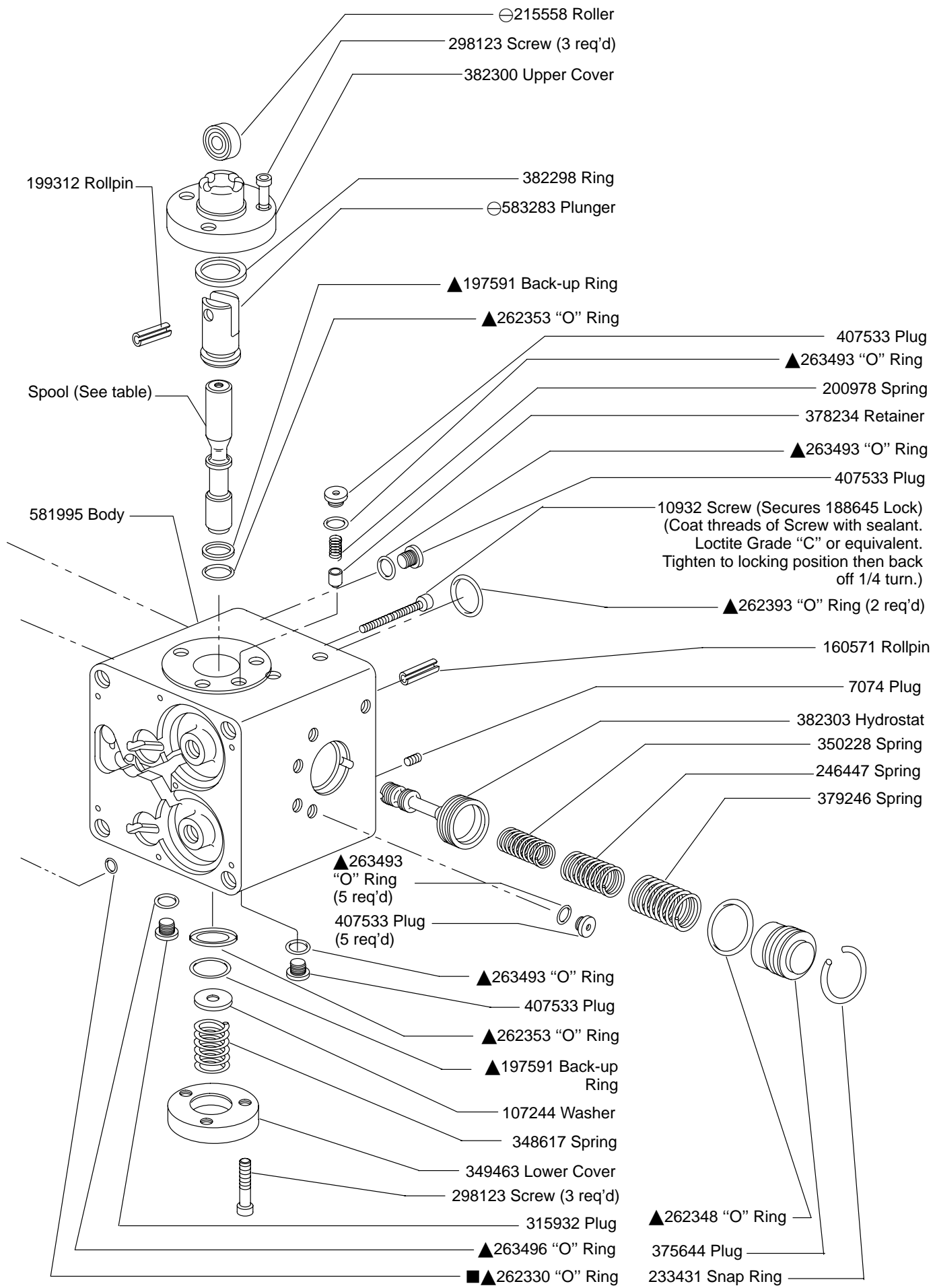

Model Code

CP G - 06 - * * - (L) - (T) - 12 (S1)

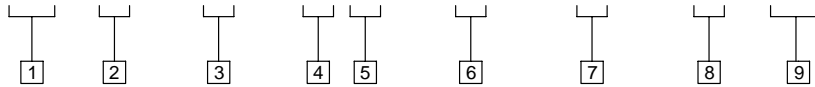

1 Model Series

CP - Control Panel

2 Mounting

G - Gasket mounted

3 3/4" Valve Size - 60 Series

4 Spool Capacity (USgpm)

10 - 10
15 - 15
20 - 20
30 - 30

5 Valve Type

A - Single Feed
AA - Dual Feed

6 Lock Option

L - Lock
(Omit for standard keyed lock.)

7 Trim Adjustment

T - Trim

8 Design

9 Rollers @ Right Angles to Mounting Face

942290 Lock Option Kit
(Single Feed Panel)
942291 Lock Option Kit
(Dual Feed Panel)

375733 Subassembly
(Replaces 188645 Lock)

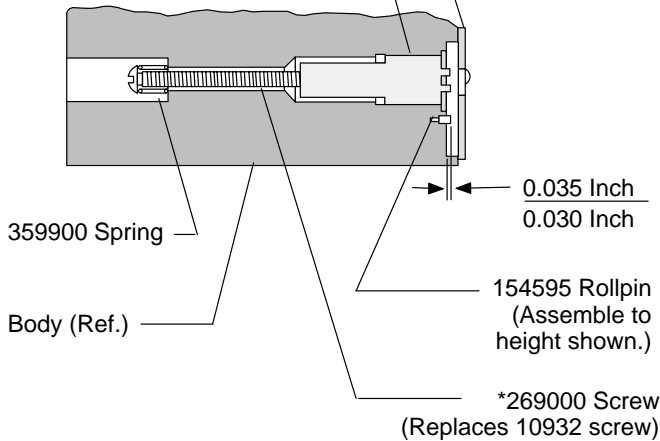

Note
Coat threads of *Screw with sealant (Loctite Grade "C" or equivalent). Tighten to locking position then back off 1/4 turn.

Lock Option
Models CPG-06--L*-12**

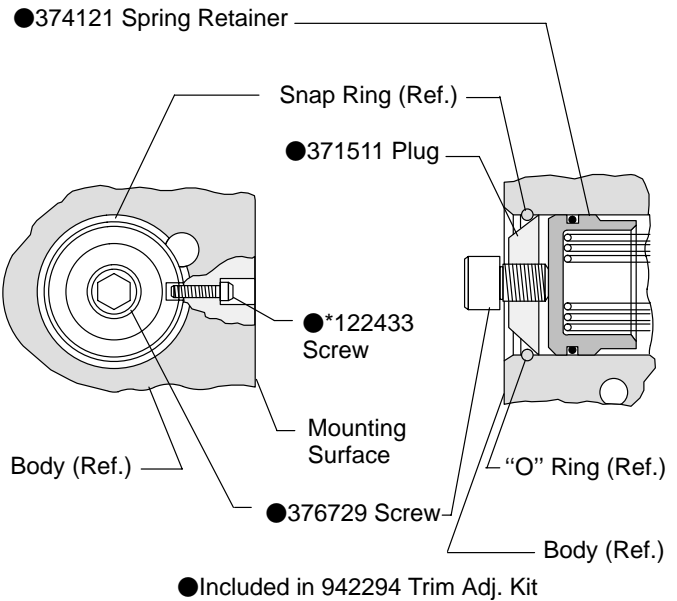

Note
Coat threads of *Screw with sealant (Loctite Grade "C" or equivalent). Tighten to locking position.

Trim Adjustment Option
Models CPG-06--T*-12**

For satisfactory service life of these components, use full flow filtration to provide fluid which meets ISO cleanliness code 20/18/15 or cleaner. Selections from Eaton OFF, OFR and OFRS filter series are recommended.